

BASIC 100.xxx.xxx - single door

Glassfibre reinforced polyester parts, sandwich construction, insulated with polyurethane foam core
Textured surface in grey RAL 7032

Protection class IP65
Vertical c-rails provided at the rear wall
Door with single point closure and lever handle, lockable

Arrangement

Floor: Sandwich-floor with PU-foam core 1.0"/ 25 mm (standard)

- Upon special request: GRP 0.2"/ 5 mm
- GRP 0.2"/ 5 mm with opening size (see [SD525](#) floor version C BASIC)

Options

- MP** Mounting plate
- FA/ FS** Acrylic glass/ Safety glass window

- SG** burglary resistant swing handle with 3-point locking device
- C-VA** Vertical c-rails in stainless steel instead of galvanized steel, aluminum available
- GO** antistatic to avoid electrostatic charges according to EN IEC 60079-0
- SB** Floor fastening
- WA** Wall fastening inside/ outside
- SZ** Ground vault for installation in the ground

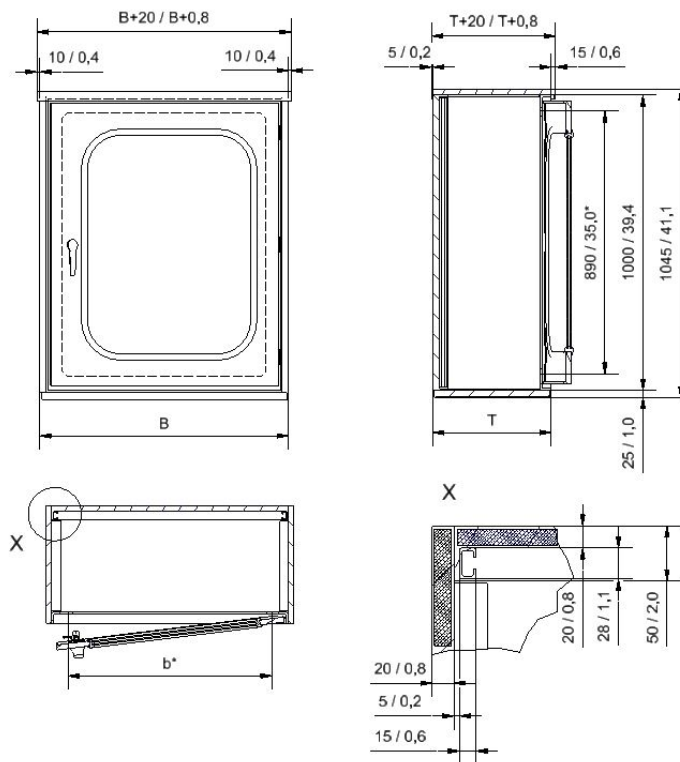

* clear opening

Dimensions in inches/ mm

Type	Sizes (inches/ mm) with floor			
	H	B	b	T
100.040.030	41.1 / 1045	17.3 / 440	11.4 / 290	11.8 / 300
100.040.040				15.8 / 400
100.040.060				23.6 / 600
100.040.080				31.5 / 800
100.040.100				39.4 / 1000
100.060.030		25.2 / 640	19.3 / 490	11.8 / 300
100.060.040				15.8 / 400
100.060.060				23.6 / 600
100.060.080				31.5 / 800
100.060.100				39.4 / 1000

Type	Sizes (inches/ mm) with floor			
	H	B	b	T
100.080.030	41.1 / 1045	33.1 / 840	27.2 / 690	11.8 / 300
100.080.040				15.8 / 400
100.080.060				23.6 / 600
100.080.080				31.5 / 800
100.080.100				39.4 / 1000
100.100.030		40.9 / 1040	35.0 / 890	11.8 / 300
100.100.040				15.8 / 400
100.100.060				23.6 / 600
100.100.080				31.5 / 800
100.100.100				39.4 / 1000

